

CENTRAL PARK TOWER La Tour SHINJUKU A4

Layout	1R	Size	30.56m ²
Monthly Basic Rent	¥ 310,000	Total Rent	
Rent breakdown			
Available Services			
24-hour bilingual concierge, housekeeping (once a week *the designated date and time), free internet, free Cable TV, water and electricity (there is a maximum amount)			
Furniture & Equipment			
Sofa, table, bed, dining table, television, DVD player, vacuum cleaner, washer/dryer, kitchen utensils, tableware, microwave, refrigerator, CATV tuner, bathroom amenities etc.			
Nearest Station	5 minute walk to Tochoumae Station (Oedo Line) 6 minute walk to Nishi Shinjuku Station (Marunouchi Line) 14 minute walk to Shinjuku Station (JR Line)		
Address	6-15-1 Nishi Shinjuku, Shinjuku-ku, Tokyo		
Structure and Scale	Steel frame, part steel frame reinforced concrete, 44 floors above ground, 2 floors below ground		
Completion	February, 2010		

If you would pay your rent by installment payment, 1 month deposit is required. 3 months or longer contract requires 1 month deposit as well. You can pay rent by credit card but not a deposit. (Deposit needs to be paid by bank transfer only.) The payment cannot be made on site. Please be sure to make the payment ahead of time. Utilities (There is a monthly limit.) and housekeeping fees are included in monthly rent. Please note actual furniture and equipment may vary from the image. Please be aware that applications will be proceeded on a first come, first served basis.

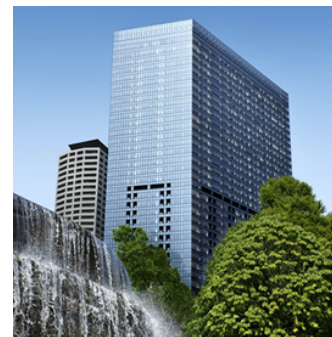
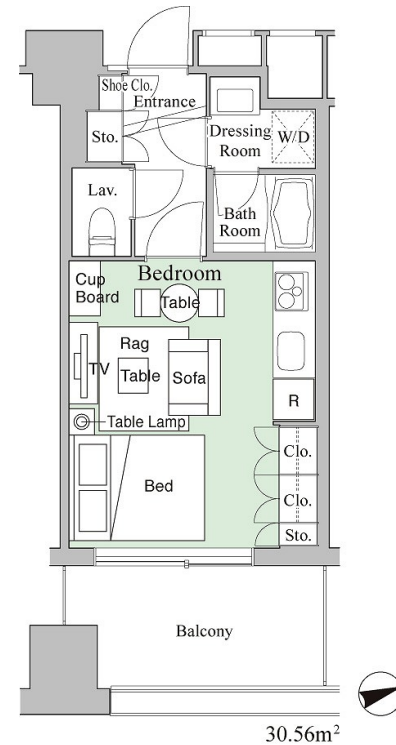

Sumitomo Realty & Development Co., Ltd.

Shinjuku NS Bldg.
4-1 Nishi-Shinjuku, 2-chome,
Shinjuku-ku, Tokyo, 163-0808 Japan

For more information on Website
WEB: <https://www.sumitomo-latour.jp/service/english/>



2019/ 10/ 19

Outside Japan : +81-3-3346-9510
Inside Japan : 0120- 770- 507