

La Tour SAPPORO ITO GARDEN Apartment No. 312 (3F)

Update Date : 2025/9/6 Next scheduled update date: Anytime

| | | | |
|----------------------------|---|---|---|
| Layout(Type) | 2LDK(L) | Area | 60.28㎡ (648.6128 sq. ft.) |
| Rent | ¥ 208,000 | Public maintenance fee Administration cost | included in rent |
| Deposit Key money | 2 Months ・ None | Renewal fee | None |
| Transaction type (Year) | Periodic Tenancy Contract (2 Years) | Status | Move in possible now (After paperwork) |
| Note | <div>24-hour concierge service with a hotel quality</div> <div>Easy access from only 8-minute walk from JR " Sapporo " station</div> <div>Environment which enables to enjoy nature of Hokkaido University Botanic Garden</div> <div>•This property is only for residential purposes, except the SOHO</div> | | |
| Equipments | Please contact us if there is any question. | | |
| Completed | February,2019 | | |
| Constructing | •Concrete-steel, 30 stories above ground and 1 base ment level, 2 stories penthouse | | |
| Location | 8-1-1, Kita 5 Jo Nishi, Chuo-ku, Sapporo-shi, Hokkaido (Parcel number) | | |
| Trains | <div>8 minute-walk from Sapporo Station (JR)</div> <div>8 minute-walk from Sapporo Station (Nanboku Line ・ Toho Line, Sapporo M unicipal Subway)</div> | | |

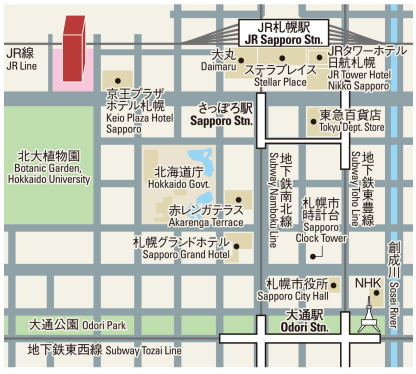

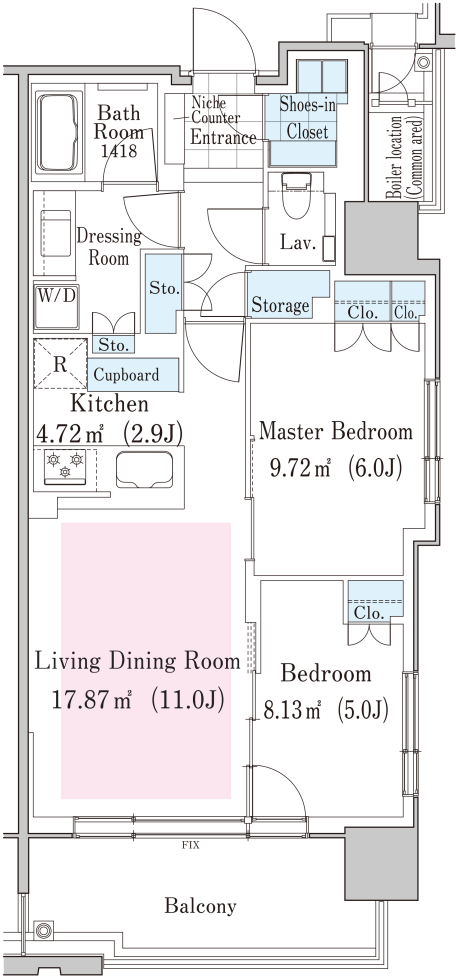

- 1 Lease guarantee agreement: required (by a guarantee company designated by us)
Guarantee fee: 30% of lease for the first year, 8,000 yen/year for the second and subsequent years
Fees may vary depending on the guarantee company - contact us for more details.
- 2 All rentals are on a first-come-first-served basis.
- 3 Multi-risk home insurance is mandatory.
- 4 Deposits equivalent to one month of rent are non-refundable at the end of the contract.
- 5 If the contract is terminated in less than one year, a penalty equivalent to one-month rent will be applied.
- 6 When disparities arise between the drawing and the actual construction, the actual construction takes precedence.

Sumitomo Realty & Development Co., Ltd.
Shinjuku NS Building, 2-4-1, Nishi-Shinjuku Shinjuku-ku, Tokyo 163-0820 Japan
Phone: +81-3-3346-9510

Phone: 0120-770-507
for Real estate company: +81-3-3346-9510
Please contact us if there is any question.