

La Tour SHIBUYA JINNAN Apartment No. 2201 (22F)

Update Date : 2025/6/29 Next scheduled update date: Anytime

Layout(Type)	2LDK(130-H)	Area	128.46㎡ (1382.2296 sq. ft.)
Rent	¥ 1,580,000	Public maintenance fee Administration cost	included in rent
Deposit Key money	2 Months • None	Renewal fee	None
Transaction type (Year)	Periodic Tenancy Contract (2 Years)	Status	Move in possible now (After paperwork)
Note	<p>Great location; 9-minute walk to Tokyu Line/Tokyo Metro “ Shibuya ” stn Designed to place all the units in the corner, valued on protecting privacy Environment which enables to enjoy nature and history from Yoyogi park 24-hour concierge service to warmly welcome residents and visitors</p> <p>•This property is only for residential purposes, except the SOHO</p>		
Equipments	Please contact us if there is any question.		
Completed	January,2019		
Constructing	•Steel-frame, reinforced concrete, 22 stories above g round and 1 basement levels		
Location	1-5-14 Jinnan, Shibuya-ku, Tokyo		
Trains	<p>Shibuya Stn., JR Line (10-min. walk) Shibuya Stn., Hanzomon/Fukutoshin L ines (9-min. walk) Harajuku Stn., JR Line (9-min. walk) Meiji-jingu-mae Stn., Chiyoda Line (8- min. walk)</p>		

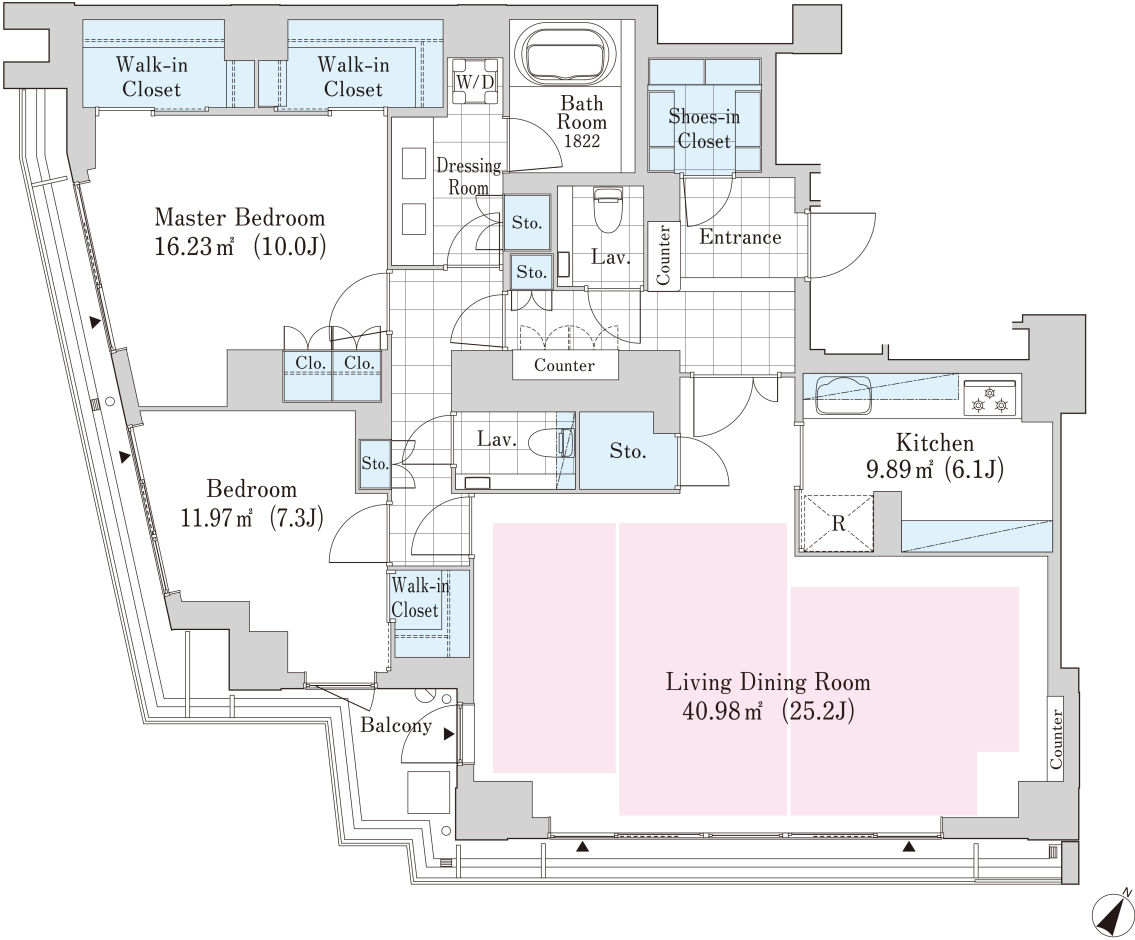

- 1 Lease guarantee agreement: required (by a guarantee company designated by us)
Guarantee fee: 30% of lease for the first year, 8,000 yen/year for the second and subsequent years
Fees may vary depending on the guarantee company - contact us for more details.
- 2 All rentals are on a first-come-first-served basis.
- 3 Multi-risk home insurance is mandatory.
- 4 Deposits equivalent to one month of rent are non-refundable at the end of the contract.
- 5 If the contract is terminated in less than one year, a penalty equivalent to one-month rent will be applied.
- 6 When disparities arise between the drawing and the actual construction, the actual construction takes precedence.

Sumitomo Realty & Development Co., Ltd.
Shinjuku NS Building, 2-4-1, Nishi-Shinjuku Shinjuku-ku, Tokyo 163-0820 Japan
Phone: +81-3-3346-9510

Phone: 0120-770-507
for Real estate company: +81-3-3346-9510
Please contact us if there is any question.