

La Tour SHIBUYA JINNAN Apartment No. 201 (2F)

Update Date : 2025/12/16 Next scheduled update date: Anytime

| | | | |
|----------------------------|--|---|---------------------------------------|
| Layout(Type) | 2LDK(80-A) | Area | 82.45㎡ (887.162 sq. ft.) |
| Rent | ¥ 720,000 | Public maintenance fee Administration cost | included in rent |
| Deposit Key money | 2 Months • None | Renewal fee | None |
| Transaction type (Year) | Periodic Tenancy Contract (2 Years) | Status | Vacancy soon (Moving out: 12/2025) |
| Note | <p>Great location; 9-minute walk to Tokyu Line/Tokyo Metro “ Shibuya ” stn Designed to place all the units in the corner, valued on protecting privacy Environment which enables to enjoy nature and history from Yoyogi park 24-hour concierge service to warmly welcome residents and visitors</p> <p>•This property is only for residential purposes, except the SOHO</p> | | |
| Equipments | Please contact us if there is any question. | | |
| Completed | January,2019 | | |
| Constructing | •Steel-frame, reinforced concrete, 22 stories above g round and 1 basement levels | | |
| Location | 1-5-14 Jinnan, Shibuya-ku, Tokyo | | |
| Trains | <p>Shibuya Stn., JR Line (10-min. walk) Shibuya Stn., Hanzomon/Fukutoshin L ines (9-min. walk) Harajuku Stn., JR Line (9-min. walk) Meiji-jingu-mae Stn., Chiyoda Line (8- min. walk)</p> | | |

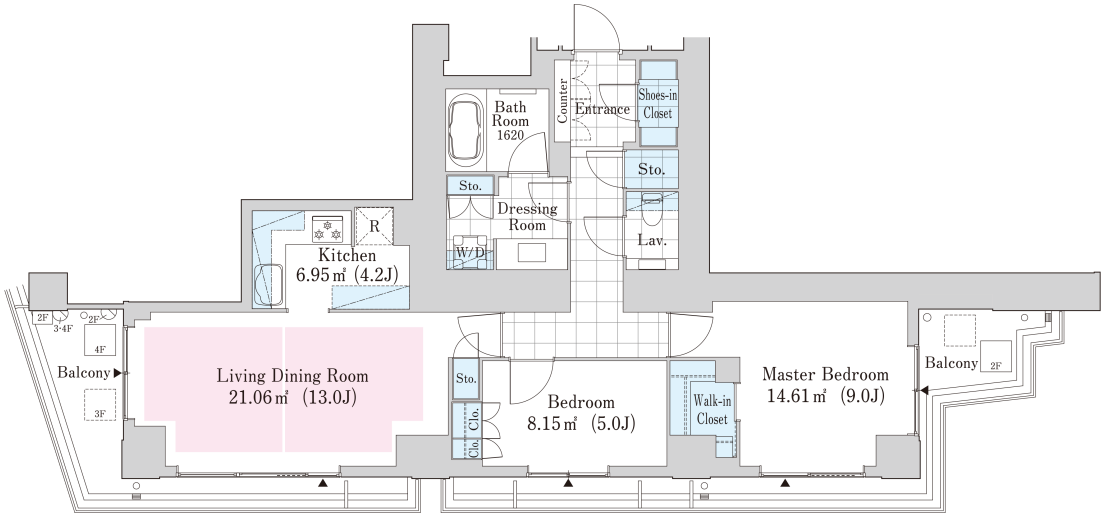

- 1 Lease guarantee agreement: required (by a guarantee company designated by us)
Guarantee fee: 30% of lease for the first year, 8,000 yen/year for the second and subsequent years
Fees may vary depending on the guarantee company - contact us for more details.
- 2 All rentals are on a first-come-first-served basis.
- 3 Multi-risk home insurance is mandatory.
- 4 Deposits equivalent to one month of rent are non-refundable at the end of the contract.
- 5 If the contract is terminated in less than one year, a penalty equivalent to one-month rent will be applied.
- 6 When disparities arise between the drawing and the actual construction, the actual construction takes precedence.

Sumitomo Realty & Development Co., Ltd.
Shinjuku NS Building, 2-4-1, Nishi-Shinjuku Shinjuku-ku, Tokyo 163-0820 Japan
Phone: +81-3-3346-9510

Phone: 0120-770-507
for Real estate company: +81-3-3346-9510
Please contact us if there is any question.