

La Tour Ichigaya-Sadohara Apartment No. W203 (2F)

Update Date : 2025/7/3 Next scheduled update date: Anytime

Layout(Type)	4LDK(J)	Area	170.64㎡ (1836.0864 sq. ft.)
Rent	¥ 1,400,000	Public maintenance fee Administration cost	included in rent
Deposit Key money	2 Months • None	Renewal fee	None
Transaction type (Year)	Periodic Tenancy Contract (2 Years)	Status	Vacancy soon (Moving out: 07/2025)
Note	<div>Advanced security system Instrument is negotiable 1 month rent will be deducted at the time of move-out.</div> <div>•This property is only for residential purposes, except the SOHO</div>		
Equipments	Please contact us if there is any question.		
Completed	March,2007		
Constructing	・ Reinforced concrete ・ 5 stories		
Location	3-17-1 Ichigaya-Sadoharacho, Shinjuku-ku, Tokyo		
Trains	<div>Ichigaya Stn., Namboku/Yurakucho Lines (7-min. walk)</div> <div>Ushigome-Kagurazaka Stn., Oedo Line (8-min. walk)</div> <div>Idabashi Stn., Namboku/Yurakucho/Tozai Lines (10-min. walk)</div> <div>Idabashi Stn., JR Line (11-min. walk)</div> <div>Ichigaya Stn., Shinjuku/JR Lines (12-min. walk)</div>		

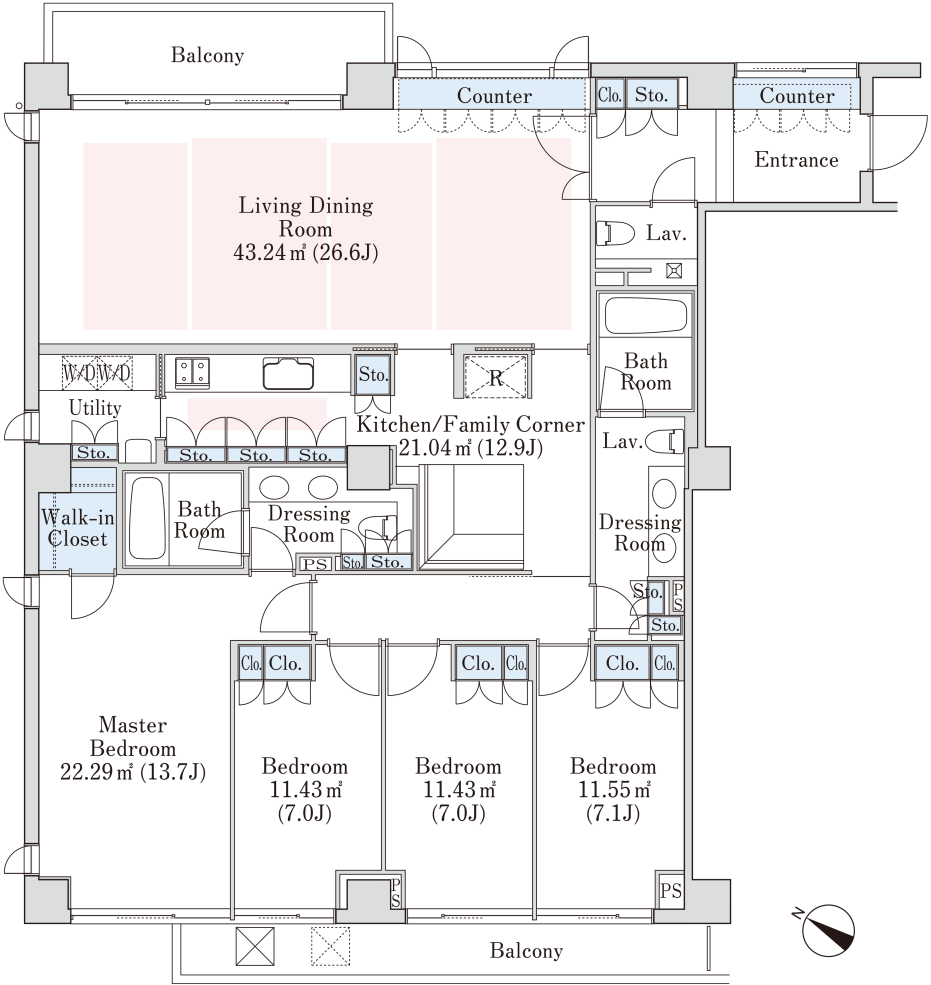

- Lease guarantee agreement: required (by a guarantee company designated by us)
Guarantee fee: 30% of lease for the first year, 8,000 yen/year for the second and subsequent years
Fees may vary depending on the guarantee company - contact us for more details.
- All rentals are on a first-come-first-served basis.
- Multi-risk home insurance is mandatory.
- Deposits equivalent to one month of rent are non-refundable at the end of the contract.
- If the contract is terminated in less than one year, a penalty equivalent to one-month rent will be applied.
- When disparities arise between the drawing and the actual construction, the actual construction takes precedence.

Sumitomo Realty & Development Co., Ltd.
Shinjuku NS Building, 2-4-1, Nishi-Shinjuku Shinjuku-ku, Tokyo 163-0820 Japan
Phone: +81-3-3346-9510

Phone: 0120-770-507
for Real estate company: +81-3-3346-9510
Please contact us if there is any question.