

ROPPONGI GRAND TOWER RESIDENCE

Apartment No. 903 (9F)

Update Date : 2024/5/2 Next scheduled update date: Anytime

Layout(Type)	1LDK(G1-60E)	Area	63.74㎡ (685.8424 sq. ft.)
Rent	¥ 579,000	Public maintenance fee Administration cost	included in rent
Deposit Key money	2 Months ・ None	Renewal fee	None
Transaction type (Year)	Periodic Tenancy Contract (3 Years)	Status	Move-in date negotiable (Being restored)
Note	•This property is only for residential purposes, except the SOHO		
Equipments	Please contact us if there is any question.		
Completed	March,2016		
Constructing	・ Steel-frame, reinforced concrete ・ Anti-sway structure construction ・ 27 stories		
Location	2-2 Roppongi-sanchome,Minato-ku,Tokyo		
Trains	Roppongi-Itchome Stn., Namboku Line (3-min. walk) Roppongi Stn., Hibiya/Oedo Lines (8-min. walk) Kamiyacho Stn., Hibiya Line (12-min. walk)		

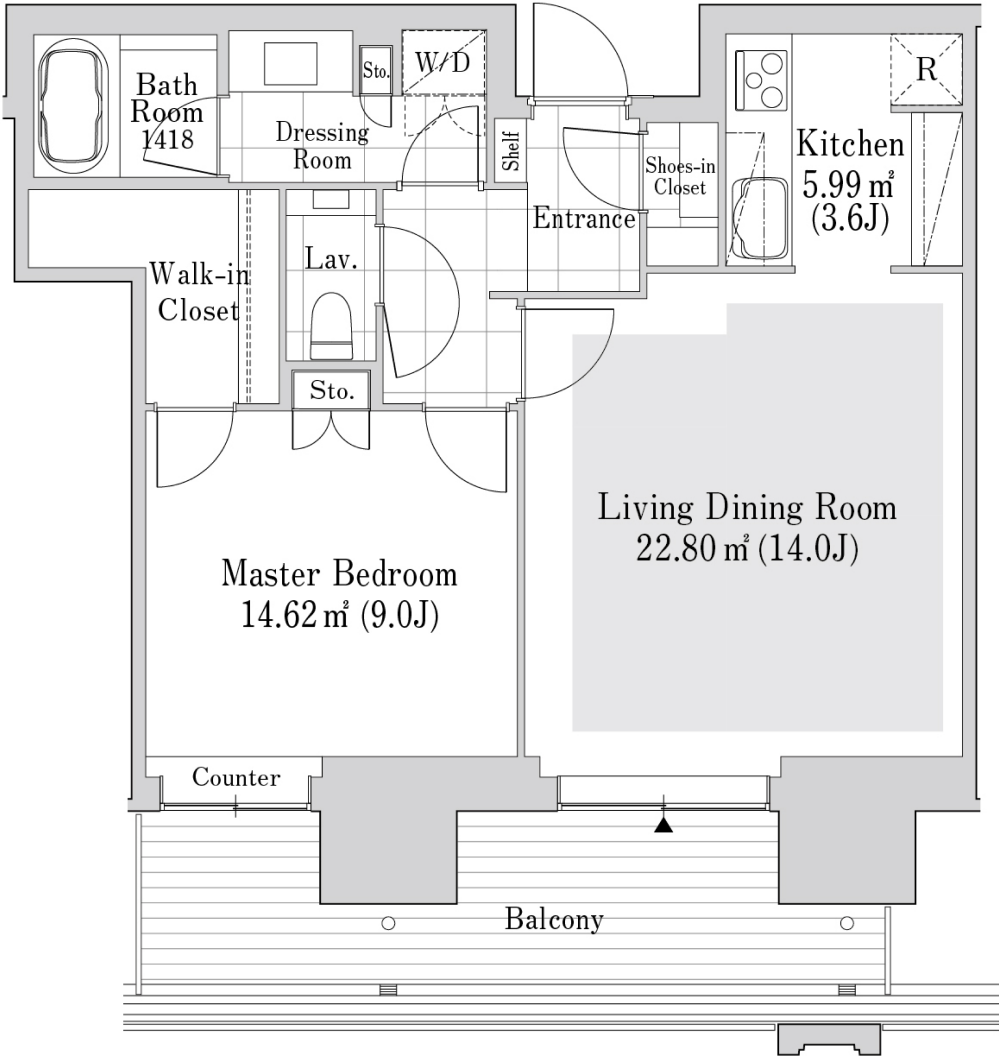

- 1 Lease guarantee agreement: required (by a guarantee company designated by us)  
Guarantee fee: 30% of lease for the first year, 8,000 yen/year for the second and subsequent years  
Fees may vary depending on the guarantee company - contact us for more details.
- 2 All rentals are on a first-come-first-served basis.
- 3 Multi-risk home insurance is mandatory.
- 4 Deposits equivalent to one month of rent are non-refundable at the end of the contract.
- 5 If the contract is terminated in less than one year, a penalty equivalent to one-month rent will be applied.
- 6 When disparities arise between the drawing and the actual construction, the actual construction takes precedence.

Sumitomo Realty & Development Co., Ltd.  
Shinjuku NS Building, 2-4-1, Nishi-Shinjuku Shinjuku-ku, Tokyo 163-0820 Japan  
Phone: +81-3-3346-9510

Phone: 0120-770-507  
for Real estate company: +81-3-3346-9510  
Please contact us if there is any question.