

La Tour Shinjuku Garden Apartment No. 3614 (36F)

Update Date : 2025/5/1 Next scheduled update date: Anytime

| | | | |
|----------------------------|---|---|---------------------------------------|
| Layout(Type) | 2LDK(N2-80N) | Area | 78.57㎡ (845.4132 sq. ft.) |
| Rent | ¥ 542,000 | Public maintenance fee Administration cost | included in rent |
| Deposit Key money | 2 Months • None | Renewal fee | None |
| Transaction type (Year) | Periodic Tenancy Contract (3 Years) | Status | Vacancy soon (Moving out: 06/2025) |
| Note | •This property is only for residential purposes, except the SOHO | | |
| Equipments | Please contact us if there is any question. | | |
| Completed | March,2016 | | |
| Constructing | • RC, SRC, Steel-Frame • Anti-sway structure • 37 Stories | | |
| Location | 3-8 Okubo, Shinjuku-ku, Tokyo | | |
| Trains | Takadanobaba Stn., JR Line (7-min. walk) Takadanobaba Stn., Tozai Line (9-min. walk) Nishi-Waseda Stn., Fukutoshin Line (9-min. walk) | | |

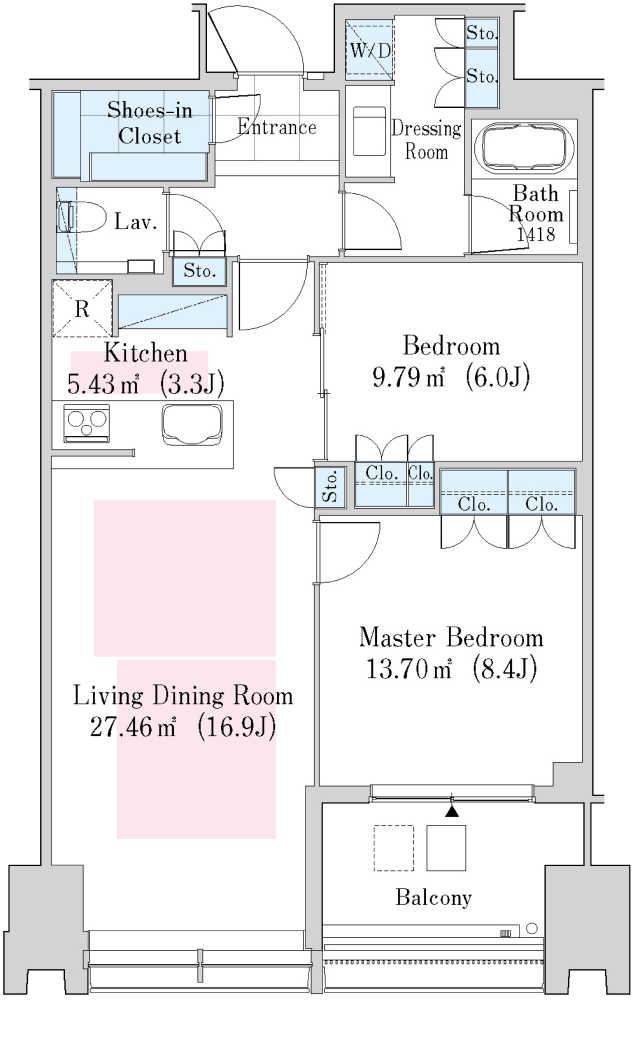



- 1 Lease guarantee agreement: required (by a guarantee company designated by us)
Guarantee fee: 30% of lease for the first year, 8,000 yen/year for the second and subsequent years
Fees may vary depending on the guarantee company - contact us for more details.
- 2 All rentals are on a first-come-first-served basis.
- 3 Multi-risk home insurance is mandatory.
- 4 Deposits equivalent to one month of rent are non-refundable at the end of the contract.
- 5 If the contract is terminated in less than one year, a penalty equivalent to one-month rent will be applied.
- 6 When disparities arise between the drawing and the actual construction, the actual construction takes precedence.

Sumitomo Realty & Development Co., Ltd.
Shinjuku NS Building, 2-4-1, Nishi-Shinjuku Shinjuku-ku, Tokyo 163-0820 Japan
Phone: +81-3-3346-9510

Phone: 0120-770-507
for Real estate company: +81-3-3346-9510
Please contact us if there is any question.