

# La Tour Iidabashi     Apartment No. 1202 (12F)

Update Date : 2025/7/27 Next scheduled update date: Anytime

|                            |   |   |                                       |
|----------------------------|---|---|---------------------------------------|
| Layout(Type)               | 1LDK(B)   | Area  | 60.60㎡ (652.056 sq. ft.)              |
| Rent                       | ¥ 430,000   | Public maintenance fee<br>Administration cost | included in rent                      |
| Deposit<br>Key money       | 2 Months • None   | Renewal fee                                   | None                                  |
| Transaction type<br>(Year) | Periodic Tenancy Contract<br>(2 Years)  | Status  | Vacancy soon<br>(Moving out: 08/2025) |
| Note                       | 24-hour Concierge<br>Sky garden, Party room<br>1 month rent will be deducted at the time of move-out.<br><br>•This property is only for residential purposes, except the SOHO |   |                                       |
| Equipments                 | Please contact us if there is any question.   |   |                                       |
| Completed                  | April,2010  |   |                                       |
| Constructing               | • Steel-frame, partial steel-frame reinforced concrete<br>• Anti-sway structure    • 34 stories   |   |                                       |
| Location                   | 2-6-1Koraku,Bunkyo-ku,Tokyo   |   |                                       |
| Trains                     | Iidabashi Stn., Oedo Line (4-min. walk)<br>Iidabashi Stn., JR/Tozai/Yurakucho/Na<br>mboku Lines (6-min. walk)<br>Korakuen Stn., Marunouchi/Namboku<br>Lines (9-min. walk)     |   |                                       |

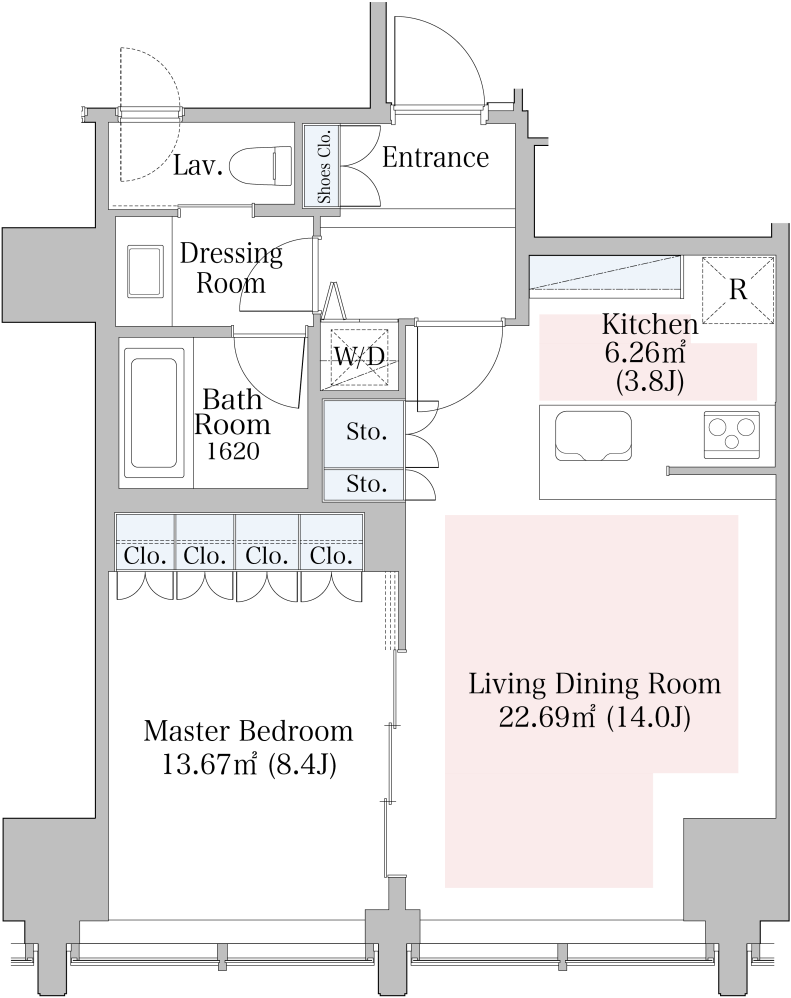

- 1 Lease guarantee agreement: required (by a guarantee company designated by us)  
Guarantee fee: 30% of lease for the first year, 8,000 yen/year for the second and subsequent years  
Fees may vary depending on the guarantee company - contact us for more details.
- 2 All rentals are on a first-come-first-served basis.
- 3 Multi-risk home insurance is mandatory.
- 4 Deposits equivalent to one month of rent are non-refundable at the end of the contract.
- 5 If the contract is terminated in less than one year, a penalty equivalent to one-month rent will be applied.
- 6 When disparities arise between the drawing and the actual construction, the actual construction takes precedence.

Sumitomo Realty & Development Co., Ltd.  
Shinjuku NS Building, 2-4-1, Nishi-Shinjuku Shinjuku-ku, Tokyo 163-0820 Japan  
Phone: +81-3-3346-9510

Phone: 0120-770-507  
for Real estate company: +81-3-3346-9510  
Please contact us if there is any question.