

# CENTRAL PARK TOWER La Tour Shinjuku Apartment No. 3007 (30F)

Update Date : 2025/9/6 Next scheduled update date: Anytime

|                            |  |   |                                       |
|----------------------------|--|---|---------------------------------------|
| Layout(Type)               | 1LDK(L2-80W)   | Area  | 82.14㎡ (883.8264 sq. ft.)             |
| Rent                       | ¥ 550,000  | Public maintenance fee<br>Administration cost | included in rent                      |
| Deposit<br>Key money       | 2 Months ・ None  | Renewal fee                                   | None                                  |
| Transaction type<br>(Year) | Periodic Tenancy Contract<br>(2 Years)   | Status  | Vacancy soon<br>(Moving out: 09/2025) |
| Note                       | •This property is only for residential purposes, except the SOHO   |   |                                       |
| Equipments                 | Please contact us if there is any question.  |   |                                       |
| Completed                  | January,2010   |   |                                       |
| Constructing               | ・ Steel construction, steel framed reinforced concrete structure, reinforced concrete construction ・ 44 stories                        |   |                                       |
| Location                   | 6-15-1 Nishi-Shinjuku, Shinjuku-ku, Tokyo  |   |                                       |
| Trains                     | Nishi-Shinjuku Stn., Marunouchi Line ( 7-min. walk)<br>Tochomae Stn., Oedo Line (5-min. walk)<br>Shinjuku Stn., JR Line (13-min. walk) |   |                                       |

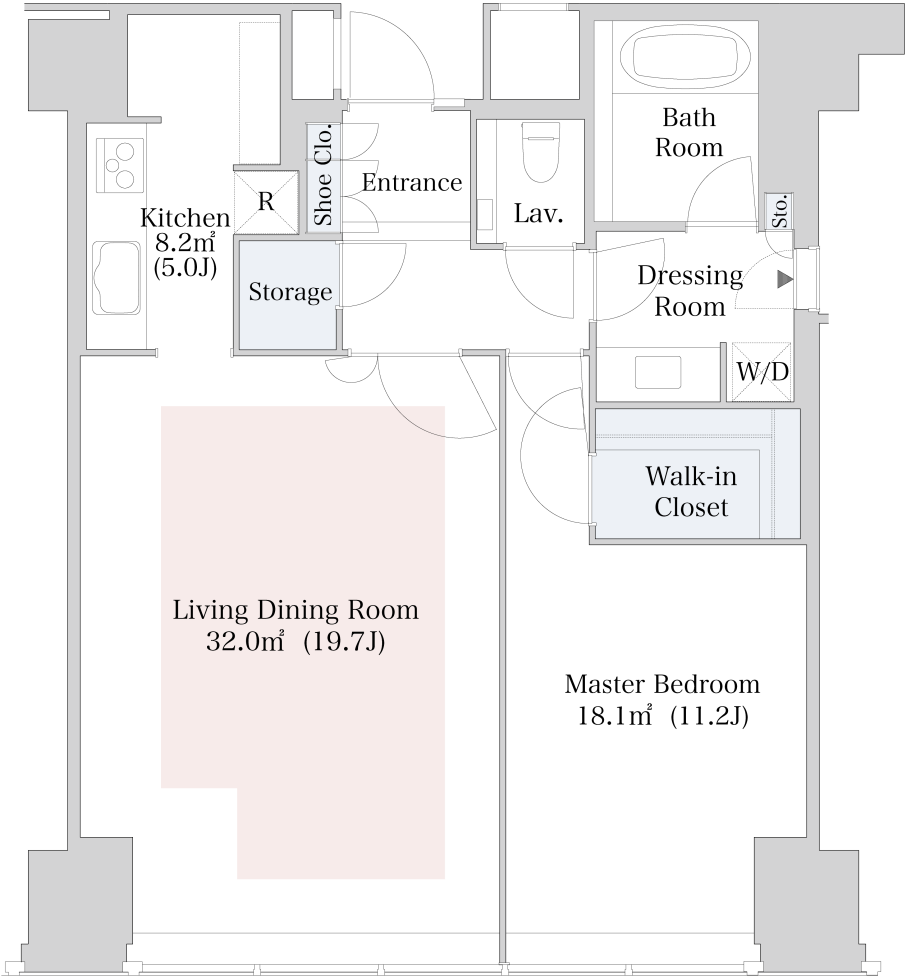

- 1 Lease guarantee agreement: required (by a guarantee company designated by us)  
Guarantee fee: 30% of lease for the first year, 8,000 yen/year for the second and subsequent years  
Fees may vary depending on the guarantee company - contact us for more details.
- 2 All rentals are on a first-come-first-served basis.
- 3 Multi-risk home insurance is mandatory.
- 4 Deposits equivalent to one month of rent are non-refundable at the end of the contract.
- 5 If the contract is terminated in less than one year, a penalty equivalent to one-month rent will be applied.
- 6 When disparities arise between the drawing and the actual construction, the actual construction takes precedence.

Sumitomo Realty & Development Co., Ltd.  
Shinjuku NS Building, 2-4-1, Nishi-Shinjuku Shinjuku-ku, Tokyo 163-0820 Japan  
Phone: +81-3-3346-9510

Phone: 0120-770-507  
for Real estate company: +81-3-3346-9510  
Please contact us if there is any question.