

La Tour Mita Apartment No. 3804 (38F)

Update Date : 2025/9/3 Next scheduled update date: Anytime

| | | | |
|----------------------------|--|---|---------------------------------------|
| Layout(Type) | 1LDK(E) | Area | 72.49㎡ (779.9924 sq. ft.) |
| Rent | ¥ 620,000 | Public maintenance fee Administration cost | included in rent |
| Deposit Key money | 2 Months • None | Renewal fee | None |
| Transaction type (Year) | Periodic Tenancy Contract (2 Years) | Status | Vacancy soon (Moving out: 09/2025) |
| Note | <div>Advanced security system 1 month rent will be deducted at the time of move-out.</div> <div>•This property is only for residential purposes, except the SOHO</div> | | |
| Equipments | Please contact us if there is any question. | | |
| Completed | September,2006 | | |
| Constructing | • Steel-frame, partially reinforced concrete • Vibrati on-control construction • 43 stories | | |
| Location | 3-5-27 Mita, Minato-ku, Tokyo | | |
| Trains | Mita Stn., Asakusa/Mita Lines (8-min. walk) Sengakuji Stn., Asakusa Line (6-min. w alk) Tamachi Stn., JR Line (9-min. walk) | | |

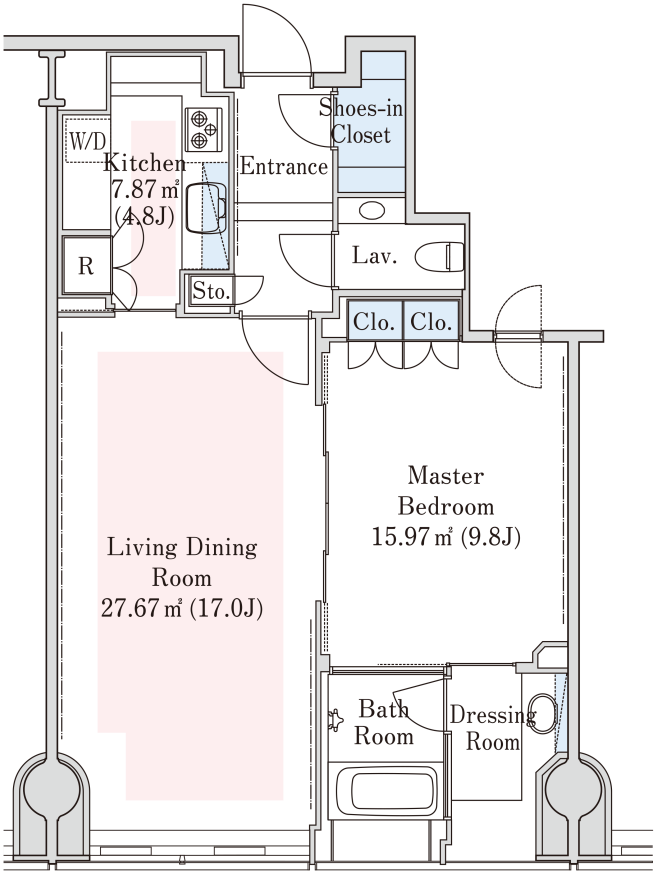

E'type

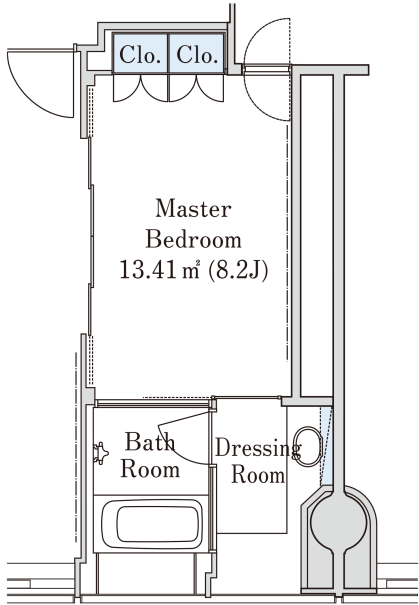

- 1 Lease guarantee agreement: required (by a guarantee company designated by us)
Guarantee fee: 30% of lease for the first year, 8,000 yen/year for the second and subsequent years
Fees may vary depending on the guarantee company - contact us for more details.
- 2 All rentals are on a first-come-first-served basis.
- 3 Multi-risk home insurance is mandatory.
- 4 Deposits equivalent to one month of rent are non-refundable at the end of the contract.
- 5 If the contract is terminated in less than one year, a penalty equivalent to one-month rent will be applied.
- 6 When disparities arise between the drawing and the actual construction, the actual construction takes precedence.

Sumitomo Realty & Development Co., Ltd.
Shinjuku NS Building, 2-4-1, Nishi-Shinjuku Shinjuku-ku, Tokyo 163-0820 Japan
Phone: +81-3-3346-9510

Phone: 0120-770-507
for Real estate company: +81-3-3346-9510
Please contact us if there is any question.