

# La Tour Chiyoda Apartment No. 3012 (30F)

Update Date : 2025/9/6 Next scheduled update date: Anytime

Layout(Type)	3LDK(J3')	Area	130.88㎡ (1408.2688 sq. ft.)
Rent	¥ 1,200,000	Public maintenance fee Administration cost	included in rent
Deposit Key money	2 Months • None	Renewal fee	None
Transaction type (Year)	Periodic Tenancy Contract (2 Years)	Status	Move in possible now (After paperwork)
Note	<div>Instrument is negotiable Through elevator to the upper floors 1 month rent will be deducted at the time of move-out.</div> <div>•This property is only for residential purposes, except the SOHO</div>		
Equipments	Please contact us if there is any question.		
Completed	January,2004		
Constructing	• Steel-frame, partially reinforced concrete • Anti-seismic response control • 32 stories		
Location	3-5-3 Nishi-Kanda, Chiyoda-ku, Tokyo		
Trains	<div>Jinbocho Stn., Hanzomon/Mita/Shinjuku Lines (6-min. walk) Suidobashi Stn., JR Line (6-min. walk) Kudanshita Stn., Hanzomon/Shinjuku/Tozai Lines (5-min. walk) Iidabashi Stn., Namboku/Oedo/Tozai/Yurakucho/JR Lines (11-min.walk)</div> <div></div>		

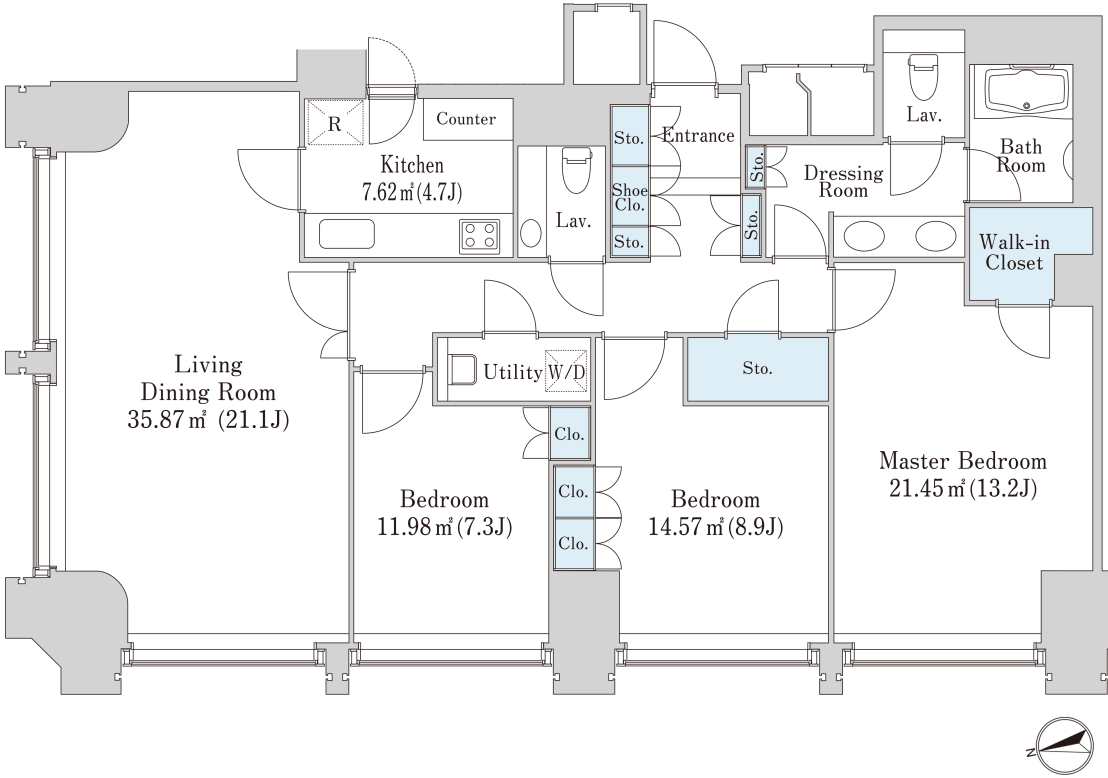

- Lease guarantee agreement: required (by a guarantee company designated by us)  
Guarantee fee: 30% of lease for the first year, 8,000 yen/year for the second and subsequent years  
Fees may vary depending on the guarantee company - contact us for more details.
- All rentals are on a first-come-first-served basis.
- Multi-risk home insurance is mandatory.
- Deposits equivalent to one month of rent are non-refundable at the end of the contract.
- If the contract is terminated in less than one year, a penalty equivalent to one-month rent will be applied.
- When disparities arise between the drawing and the actual construction, the actual construction takes precedence.

Sumitomo Realty & Development Co., Ltd.  
Shinjuku NS Building, 2-4-1, Nishi-Shinjuku Shinjuku-ku, Tokyo 163-0820 Japan  
Phone: +81-3-3346-9510

Phone: 0120-770-507  
for Real estate company: +81-3-3346-9510  
Please contact us if there is any question.