

# La Tour Chiyoda Apartment No. 2505 (25F)

Update Date : 2024/5/5 Next scheduled update date: Anytime

|                            |  |   |                                       |
|----------------------------|--|---|---------------------------------------|
| Layout(Type)               | 1LDK(L1)   | Area  | 53.49㎡ (575.5524 sq. ft.)             |
| Rent                       | ¥ 365,000  | Public maintenance fee<br>Administration cost | included in rent                      |
| Deposit<br>Key money       | 2 Months • None  | Renewal fee                                   | None                                  |
| Transaction type<br>(Year) | Periodic Tenancy Contract<br>(3 Years)   | Status  | Vacancy soon<br>(Moving out: 06/2024) |
| Note                       | <div>Limited term contract (3years)<br/>Pet is negotiable<br/>Instrument is negotiable<br/>Through elevator to the upper floors<br/>1 month rent will be deducted at the time of move-out.</div> <div>•This property is only for residential purposes, except the SOHO</div>   |   |                                       |
| Equipments                 | Please contact us if there is any question.  |   |                                       |
| Completed                  | January,2004   |   |                                       |
| Constructing               | • Steel-frame, partially reinforced concrete • Anti-seismic response control • 32 stories  |   |                                       |
| Location                   | 3-5-3 Nishi-Kanda, Chiyoda-ku, Tokyo   |   |                                       |
| Trains                     | <div>Jinbocho Stn., Hanzomon/Mita/Shinjuku Lines (6-min. walk)<br/>Suidobashi Stn., JR Line (6-min. walk)<br/>Kudanshita Stn., Hanzomon/Shinjuku/Tozai Lines (5-min. walk)<br/>Iidabashi Stn., Namboku/Oedo/Tozai/Yurakucho/JR Lines (11-min.walk)</div> <div></div> |   |                                       |

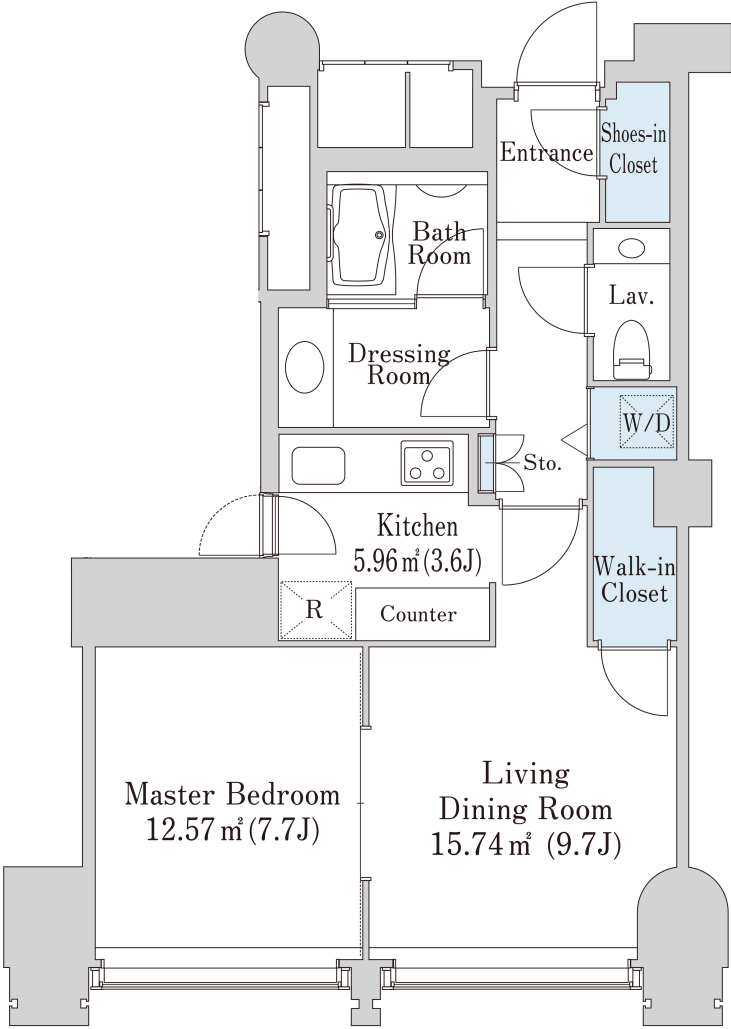

- Lease guarantee agreement: required (by a guarantee company designated by us)  
Guarantee fee: 30% of lease for the first year, 8,000 yen/year for the second and subsequent years  
Fees may vary depending on the guarantee company - contact us for more details.
- All rentals are on a first-come-first-served basis.
- Multi-risk home insurance is mandatory.
- Deposits equivalent to one month of rent are non-refundable at the end of the contract.
- If the contract is terminated in less than one year, a penalty equivalent to one-month rent will be applied.
- When disparities arise between the drawing and the actual construction, the actual construction takes precedence.

Sumitomo Realty & Development Co., Ltd.  
Shinjuku NS Building, 2-4-1, Nishi-Shinjuku Shinjuku-ku, Tokyo 163-0820 Japan  
Phone: +81-3-3346-9510

Phone: 0120-770-507  
for Real estate company: +81-3-3346-9510  
Please contact us if there is any question.