

# La Tour Shibakoen II     Apartment No. 3004 (30F)

Update Date : 2025/8/19 Next scheduled update date: Anytime

Layout(Type)	1LDK(L-R1)	Area	62.91㎡ (676.9116 sq. ft.)
Rent	¥ 570,000	Public maintenance fee Administration cost	included in rent
Deposit Key money	2 Months • None	Renewal fee	None
Transaction type (Year)	Periodic Tenancy Contract (2 Years)	Status	Vacancy soon (Moving out: 08/2025)
Note	<div>Limited term contract (3years) 24hours manned admin. Fitness room is available Pet is negotiable 1 month rent will be deducted at the time of move-out.</div> <div>•This property is only for residential purposes, except the SOHO</div>		
Equipments	Please contact us if there is any question.		
Completed	July,2001		
Constructing	• Steel-frame, reinforced concrete • Dual anti-earthquake system • 30 stories		
Location	2-11-1 Shiba-Koen, Minato-ku, Tokyo		
Trains	Shibakoen Stn., Mita Line (3-min. walk) ) Daimon Stn., Asakusa/Oedo Lines (7-min. walk) Hamamatsu Stn., Tokyo Monorail/JR Line (8-min. walk)		

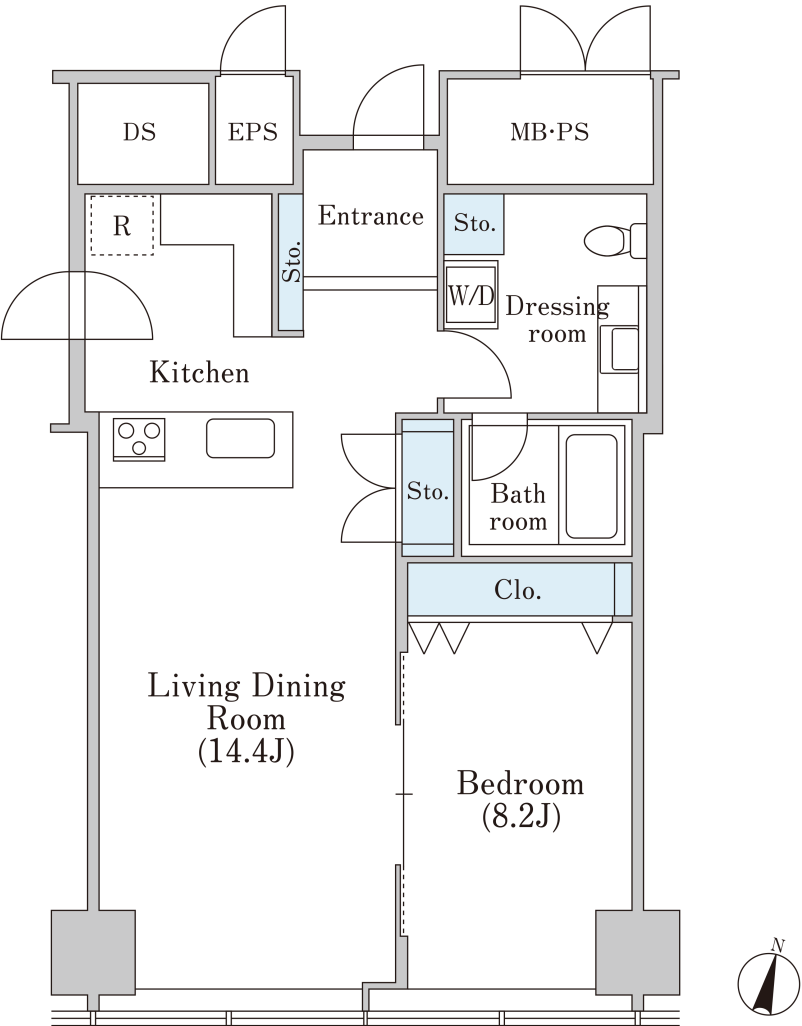



- Lease guarantee agreement: required (by a guarantee company designated by us)  
Guarantee fee: 30% of lease for the first year, 8,000 yen/year for the second and subsequent years  
Fees may vary depending on the guarantee company - contact us for more details.
- All rentals are on a first-come-first-served basis.
- Multi-risk home insurance is mandatory.
- Deposits equivalent to one month of rent are non-refundable at the end of the contract.
- If the contract is terminated in less than one year, a penalty equivalent to one-month rent will be applied.
- When disparities arise between the drawing and the actual construction, the actual construction takes precedence.

Sumitomo Realty & Development Co., Ltd.  
Shinjuku NS Building, 2-4-1, Nishi-Shinjuku Shinjuku-ku, Tokyo 163-0820 Japan  
Phone: +81-3-3346-9510

Phone: 0120-770-507  
for Real estate company: +81-3-3346-9510  
Please contact us if there is any question.