

Yokoso Rainbow Tower Heights Apartment No. 1704 (17F)

Update Date : 2025/9/6 Next scheduled update date: Anytime

Layout(Type)	1LDK(B)	Area	63.45㎡ (682.722 sq. ft.)
Rent	¥ 250,000	Public maintenance fee Administration cost	included in rent
Deposit Key money	2 Months ・ None	Renewal fee	None
Transaction type (Year)	Periodic Tenancy Contract (3 Years)	Status	Move in possible now (After paperwork)
Note	<div>Auto-lock A/C installed Instrument is negotiable 1 month rent will be deducted at the time of move-out.</div> <div>•This property is only for residential purposes, except the SOHO</div>		
Equipments	Please contact us if there is any question.		
Completed	September,2002		
Constructing	・ Steel-frame, partially reinforced concrete ・ 23 stor ies		
Location	3-20-20 Kaigan, Minato-ku, Tokyo		
Trains	Shibaurafuto Stn., Yurikamome Line (3-min. walk) Tamachi Stn., JR Line (14-min. walk)		

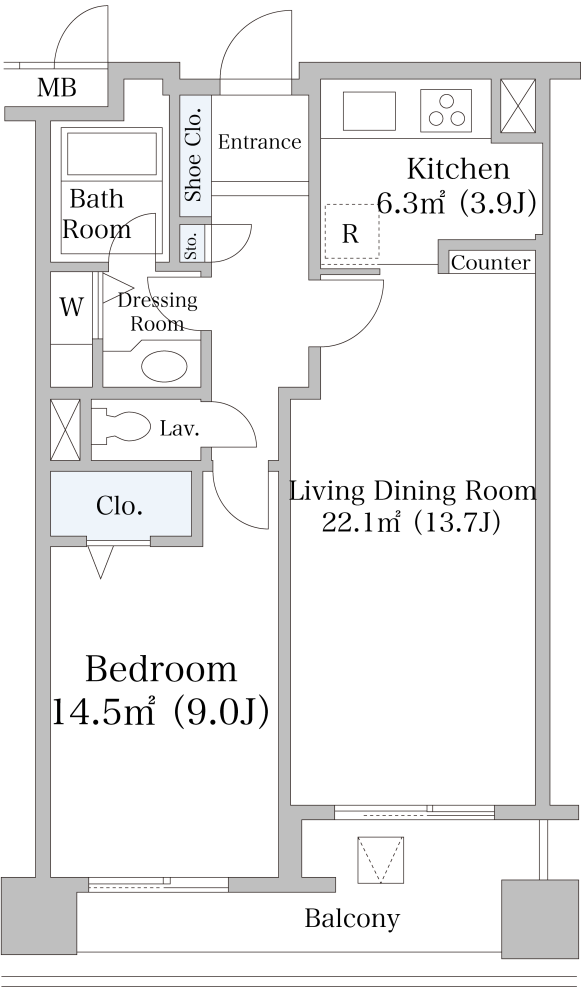

- 14F～18F
01～05号室
06～10号室
- 19F～20F
01～04号室
05～08号室
- 21F～23F
01～03号室
04～06号室

- Lease guarantee agreement: required (by a guarantee company designated by us)
Guarantee fee: 30% of lease for the first year, 8,000 yen/year for the second and subsequent years
Fees may vary depending on the guarantee company - contact us for more details.
- All rentals are on a first-come-first-served basis.
- Multi-risk home insurance is mandatory.
- Deposits equivalent to one month of rent are non-refundable at the end of the contract.
- If the contract is terminated in less than one year, a penalty equivalent to one-month rent will be applied.
- When disparities arise between the drawing and the actual construction, the actual construction takes precedence.

Sumitomo Realty & Development Co., Ltd.
Shinjuku NS Building, 2-4-1, Nishi-Shinjuku Shinjuku-ku, Tokyo 163-0820 Japan
Phone: +81-3-3346-9510

Phone: 0120-770-507
for Real estate company: +81-3-3346-9510
Please contact us if there is any question.