

Nichirei Higashi Ginza Residence Apartment No. 1808 (18F)

Update Date : 2025/8/26 Next scheduled update date: Anytime

Layout(Type)	3LDK(D')	Area	114.43㎡ (1231.2668 sq. ft.)
Rent	¥ 648,000	Public maintenance fee Administration cost	¥ 40,000
Deposit Key money	2 Months • None	Renewal fee	1 Month
Transaction type (Year)	Regular Tenancy Contract (2 Years)	Status	Move-in date negotiable (Being restored)
Note	•This property is only for residential purposes, except the SOHO		
Equipments	Please contact us if there is any question.		
Completed	January,1991		
Constructing	・ Steel frame, partially reinforced concrete ・ 22 stories		
Location	6-19-21Tsukiji,Chuo-ku,Tokyo		
Trains	Tsukiji Stn., Hibiya Line (7-min walk) Tsukiji-shijo Stn., Oedo Line (11-min walk)		

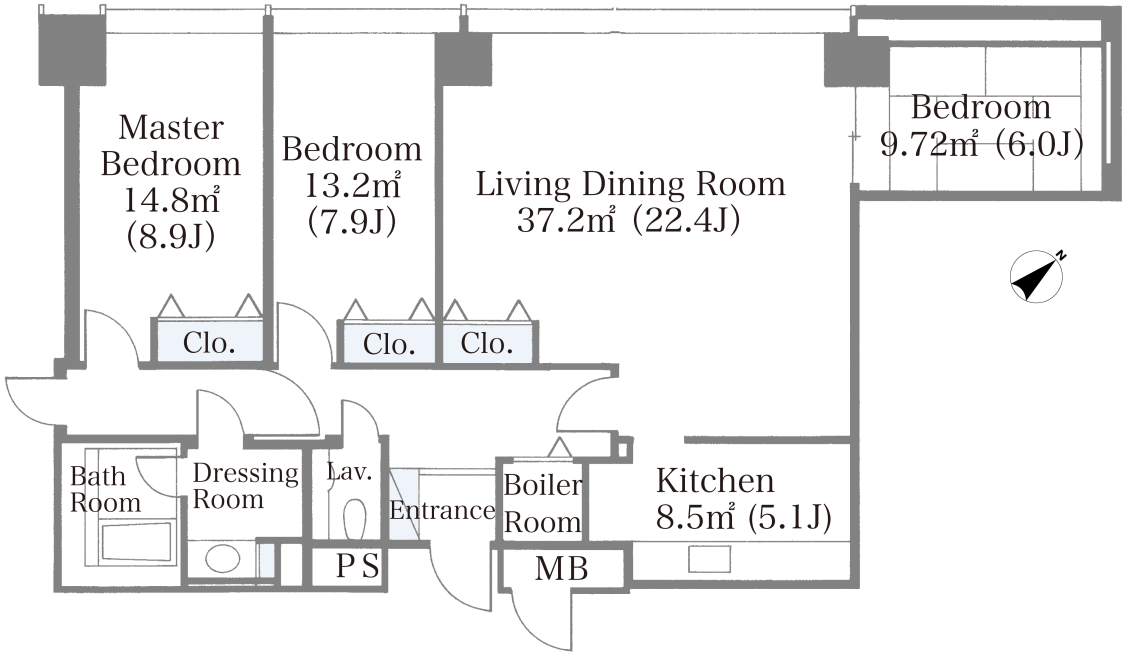



- 1 Lease guarantee agreement: required (by a guarantee company designated by us)
Guarantee fee: 30% of lease for the first year, 8,000 yen/year for the second and subsequent years
Fees may vary depending on the guarantee company - contact us for more details.
- 2 All rentals are on a first-come-first-served basis.
- 3 Multi-risk home insurance is mandatory.
- 4 Deposits equivalent to one month of rent are non-refundable at the end of the contract.
- 5 If the contract is terminated in less than one year, a penalty equivalent to one-month rent will be applied.
- 6 When disparities arise between the drawing and the actual construction, the actual construction takes precedence.

Sumitomo Realty & Development Co., Ltd.
Shinjuku NS Building, 2-4-1, Nishi-Shinjuku Shinjuku-ku, Tokyo 163-0820 Japan
Phone: +81-3-3346-9510

Phone: 0120-770-507
for Real estate company: +81-3-3346-9510
Please contact us if there is any question.