

Kachidoki Residence Apartment No. 902 (9F)

Update Date : 2024/4/29 Next scheduled update date: Anytime

| | | | |
|----------------------------|--|---|---|
| Layout(Type) | 2LDK(D-R1) | Area | 73.23㎡ (787.9548 sq. ft.) |
| Rent | ¥ 355,000 | Public maintenance fee Administration cost | included in rent |
| Deposit Key money | 2 Months ・ None | Renewal fee | None |
| Transaction type (Year) | Periodic Tenancy Contract (3 Years) | Status | Move-in date negotiable (Being restored) |
| Note | •This property is only for residential purposes, except the SOHO | | |
| Equipments | Please contact us if there is any question. | | |
| Completed | February,1993 | | |
| Constructing | ・ Steel frame ・ 10 Stories | | |
| Location | 6-1-15 Kachidoki ,Chuo-ku ,Tokyo | | |
| Trains | Kachidoki Stn., Oedo Line (7-min walk) | | |

Campaign On



*If the promotion is applicable, cancellation in less than 13 months will incur a 1-month penalty fee.
If not, cancellation in less than 1 year will incur a 1-month penalty fee.

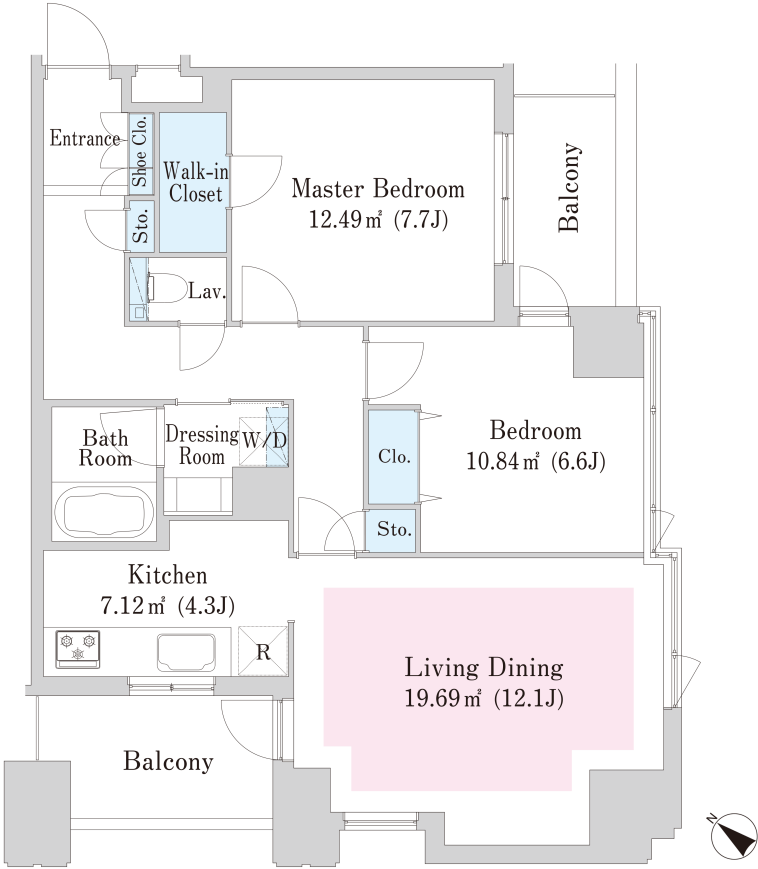

- Lease guarantee agreement: required (by a guarantee company designated by us)
Guarantee fee: 30% of lease for the first year, 8,000 yen/year for the second and subsequent years
Fees may vary depending on the guarantee company - contact us for more details.
- All rentals are on a first-come-first-served basis.
- Multi-risk home insurance is mandatory.
- Deposits equivalent to one month of rent are non-refundable at the end of the contract.
- If the contract is terminated in less than one year, a penalty equivalent to one-month rent will be applied.
- When disparities arise between the drawing and the actual construction, the actual construction takes precedence.

Sumitomo Realty & Development Co., Ltd.
Shinjuku NS Building, 2-4-1, Nishi-Shinjuku Shinjuku-ku, Tokyo 163-0820 Japan
Phone: +81-3-3346-9510

Phone: 0120-770-507
for Real estate company: +81-3-3346-9510
Please contact us if there is any question.